

FEATURES

- ' Seven models to choose from ranging in size from 6,000 to 32,800 BTUH
- ' Units are constructed of corrosion resistant aluminum, stainless steel and ABS plastic
- ' 1050 RPM motors for quiet operation
- ' Panels insulated internally to prevent external condensation
- ' Field conversion of units from vertical to horizontal configuration (or vice versa) is possible through the use of interchangeable panel construction
- ' Washable return air filter is standard on the AQP and AQV series fan coils
- ' Optional internally mounted incoloy rod type heating elements available for either single or three phase input
- ' Three-way motorized water valve is standard and can be field mounted on either side of the fan coil
- ' Insulated and internally coated stainless steel drain pan with anti-slosh foam media inside
- ' Condensate outlets on both sides of the fan coil
- ' Fresh air makeup connection is standard on the AQP and AQV units
- ' ABS blower housings with aluminum impellers
- ' Adjustable mounting legs with rubber vibration pads and mounting screws.
- ' Supply duct mounted air bleeder for easy commissioning
- ' Units available for 115/1/60, 100/1/50, 208-230/1/60 and 200-220/1/50 power inputs.
- ' All unit coil assemblies are pressure tested to assure leak-proof performance
- ' All fan motors are test run to assure proper operation and air flow output

I:\wordpfct\80930.wpd

AQUA-AIR MANUFACTURING, division of the James D. Nall Co., Inc.
1050 East 9th Street, Hialeah, Florida 33010 U.S.A.
Ph. 305-884-8363 Fax 305-883-8549

Fan Coil Specifications

| Unit Size | | 2 | 3 | 4 | 6 | 8 | 10 | 12 |
|---------------------------------------|--------------------------|----------|----------|----------|----------|----------|-----------|-----------|
| Cooling Capacity | BTU/HR | 6,000 | 9,000 | 12,100 | 17,300 | 22,600 | 27,500 | 32,800 |
| | KCAL/HR | 1,512 | 2,268 | 3,049 | 4,360 | 5,695 | 6,930 | 8,266 |
| Air Flow Capacity | CFM | 200 | 300 | 400 | 600 | 800 | 1,000 | 1,200 |
| | M³H | 340 | 510 | 680 | 1,020 | 1,360 | 1,700 | 2,040 |
| Fan Amperage | 115v | 2.70 | 2.70 | 2.70 | 2.70 | 5.40 | 5.40 | 5.40 |
| | 230v | 1.35 | 1.35 | 1.35 | 1.35 | 2.70 | 2.70 | 2.70 |
| Fan Wattage | W | 311 | 311 | 311 | 311 | 621 | 621 | 621 |
| Required Chillwater Flow | GPM | 1.2 | 1.8 | 2.4 | 3.6 | 4.8 | 6.0 | 7.2 |
| | LPM | 4.5 | 6.8 | 9.1 | 13.6 | 18.2 | 22.7 | 27.3 |
| Pressure Drop | Ft/H₂O | 2.10 | 5.00 | 3.70 | 6.20 | 8.50 | 11.40 | 17.0 |
| | kPa | 6.28 | 14.95 | 11.06 | 18.54 | 25.42 | 34.09 | 50.83 |
| Maximum Heater Size | kW | 1.0 | 1.5 | 2.0 | 3.0 | 4.0 | 5.0 | 6.0 |
| | BTU/HR | 3,415 | 5,123 | 6,830 | 10,245 | 13,660 | 17,075 | 20,490 |
| | KCAL/HR | 861 | 1,291 | 1,721 | 2,582 | 3,442 | 4,303 | 5,164 |
| Auxiliary Heater Size | kW | 1.0 | 1.0 | 1.0 | 1.5 | 2.0 | 3.0 | 3.0 |
| | BTU/HR | 3,415 | 3,415 | 3,415 | 5,123 | 6,830 | 10,245 | 10,245 |
| | KCAL/HR | 861 | 861 | 861 | 1,291 | 1,721 | 2,582 | 2,582 |
| Weight | LBS | 47 | 50 | 61 | 72 | 93 | 103 | 114 |
| | KGS | 21.4 | 22.8 | 27.8 | 32.8 | 42.3 | 46.9 | 51.9 |
| Minimum Supply Air Grille Size | in² | 56 | 72 | 96 | 128 | 160 | 200 | 240 |
| | cm² | 361 | 464 | 619 | 826 | 1,032 | 1,290 | 1,548 |
| Minimum Return Air Grille Size | in² | 84 | 108 | 144 | 192 | 240 | 300 | 360 |
| | cm² | 542 | 697 | 929 | 1,238 | 1,548 | 1,935 | 2,322 |

Fan Coil Dimensions

| Unit Size | | | 2 | 3 | 4 | 6 | 8 | 10 | 12 |
|-----------------------------|----|-------|-----------------|---------|---------|---------|----------|----------|----------|
| Length | A | in/cm | 20 / 51 | 24 / 61 | 30 / 76 | 38 / 97 | 46 / 117 | 56 / 142 | 66 / 168 |
| Depth | B | in/cm | 10.8 / 27 | | | | | | |
| Height | C | in/cm | 21 / 53 | | | | | | |
| Height (AQH only) | CH | in/cm | 19 / 48 | | | | | | |
| Air outlet length | D | in/cm | 14 / 36 | 18 / 46 | 24 / 61 | 32 / 81 | 40 / 102 | 50 / 127 | 60 / 153 |
| Air outlet width | E | in/mm | 4.0 / 102 | | | | | | |
| Unit Side to Air Outlet | F | in/mm | 3.0 / 76 | | | | | | |
| Valve Package Width | K | in/mm | 4 / 102 | | | | | | |
| Unit Front to Air Outlet | M | in/mm | 1.75 / 44 | | | | | | |
| Air Outlet Collar Height | N | in/mm | 1.0 / 25 | | | | | | |
| Valve Package Pan Length | T | in/cm | 9.0 / 23 | | | | | | |
| Valve Package Pan Height | V | in/cm | 12.50 / 32 | | | | | | |
| Chillwater Return, OD | 1 | in/mm | 0.625 / 16 | | | | | | |
| Chillwater Supply, OD | 2 | in/mm | 0.625 / 16 | | | | | | |
| Heater Electrical Inlet, ID | 3 | in/mm | 0.7 / 18 | | | | | | |
| Drain, FPT | 4 | in | 3/4 | | | | | | |
| Fresh Air Connection | 5 | in/mm | 3.0 / 76 | | | | | | |
| Unit Wiring Entrance | 6 | in/mm | 0.7 / 18 | | | | | | |
| Air Bleeder | 7 | in | 1/4" Male Flare | | | | | | |

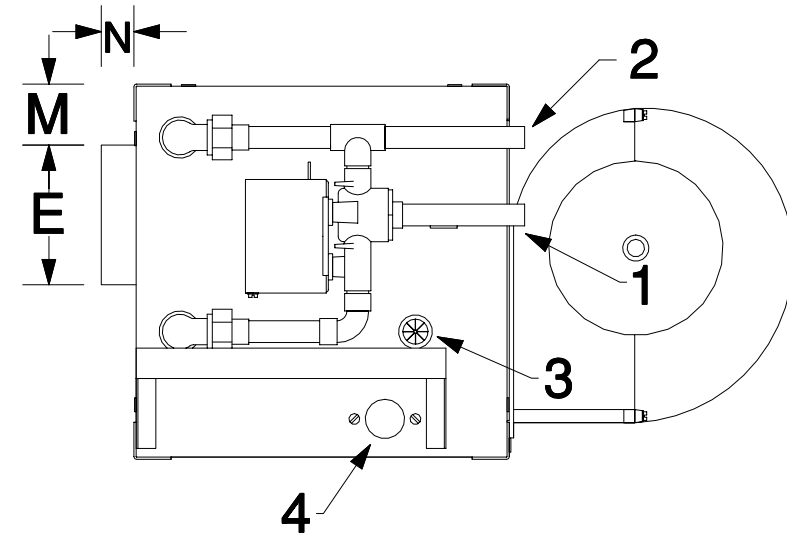
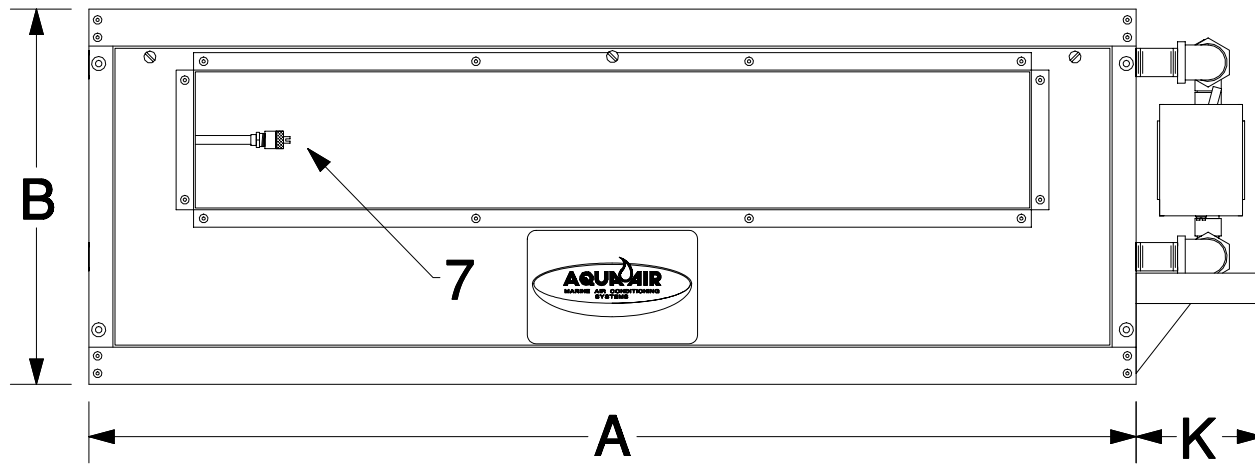

AQH-Ø4 SHOWN

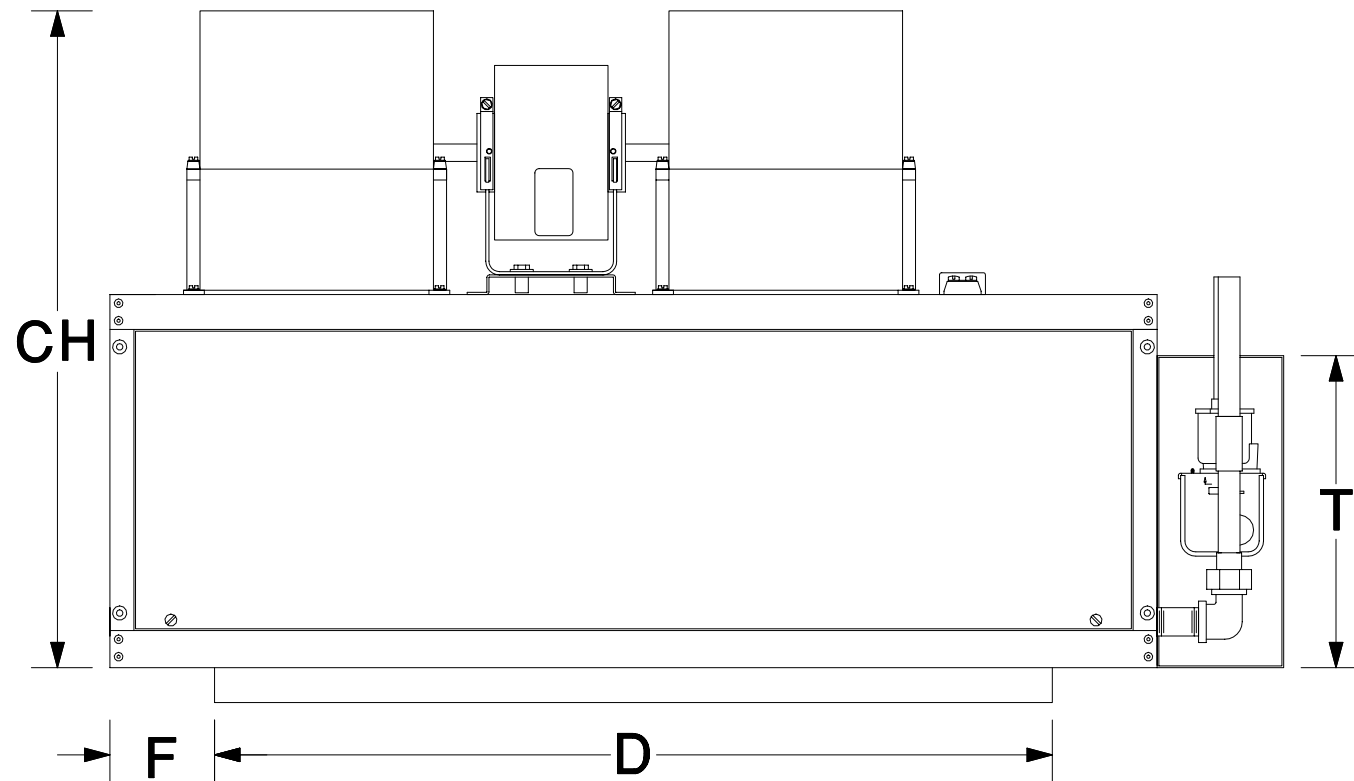

AQH
FAN COIL

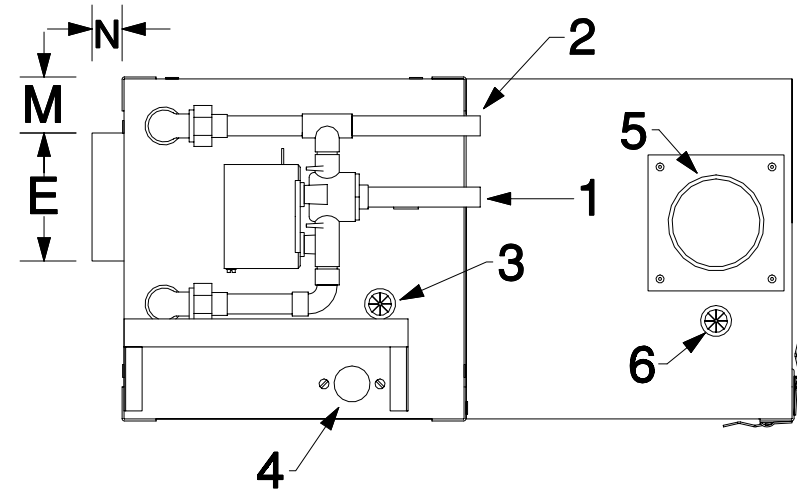
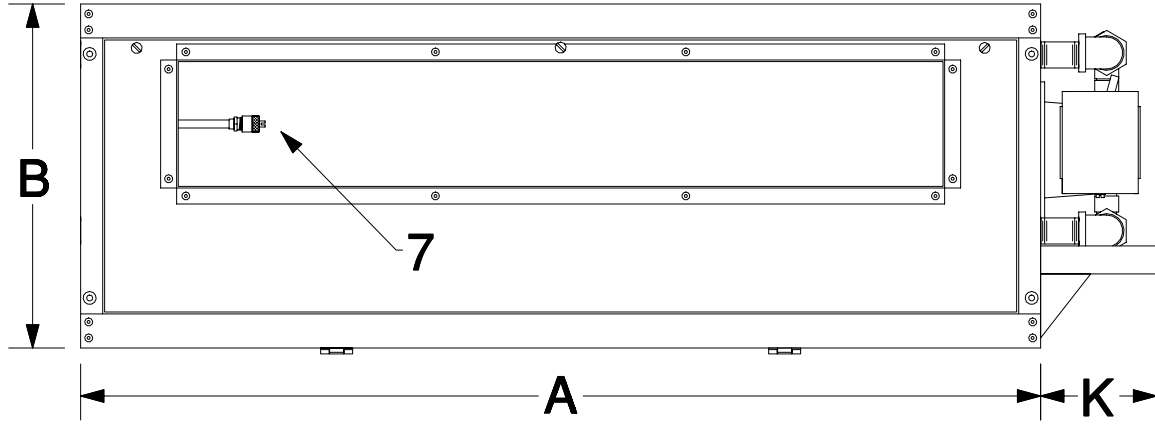

AQP-04 MODEL SHOWN

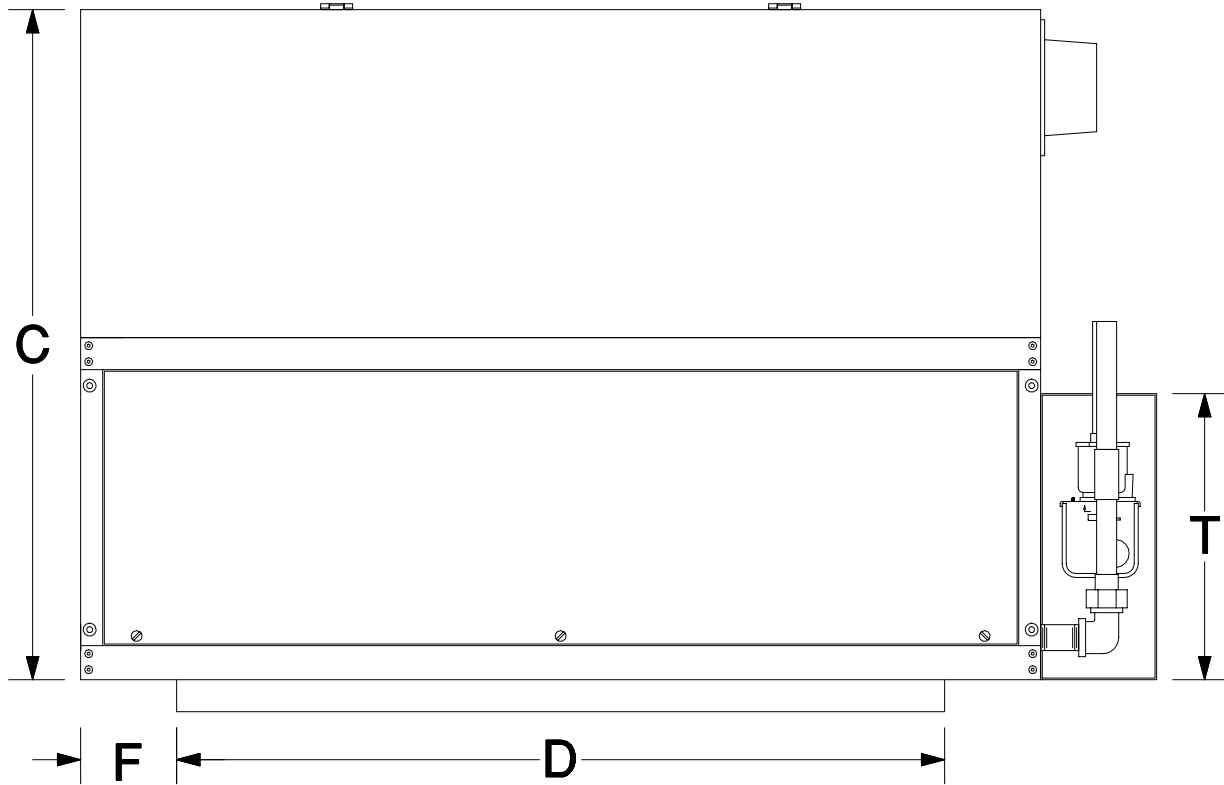

AQP

FAN COIL

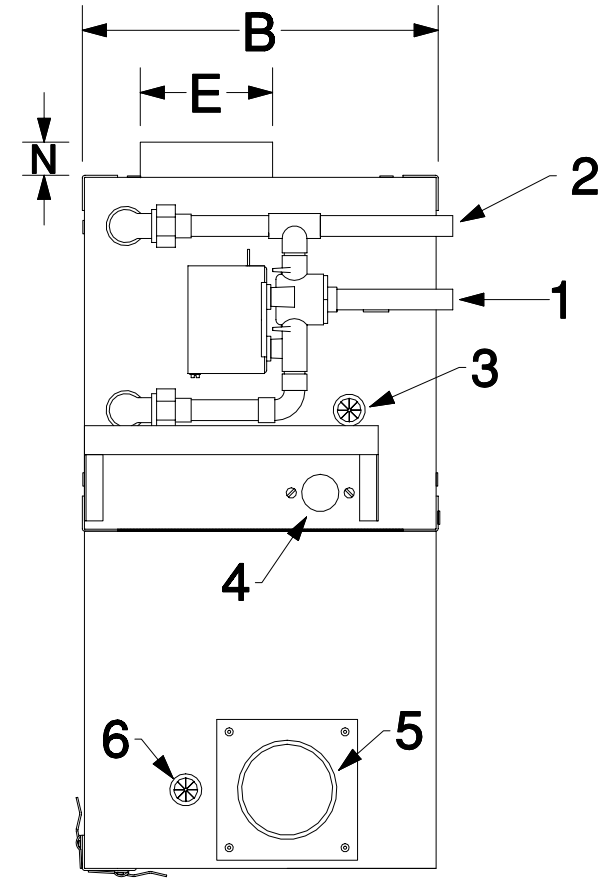
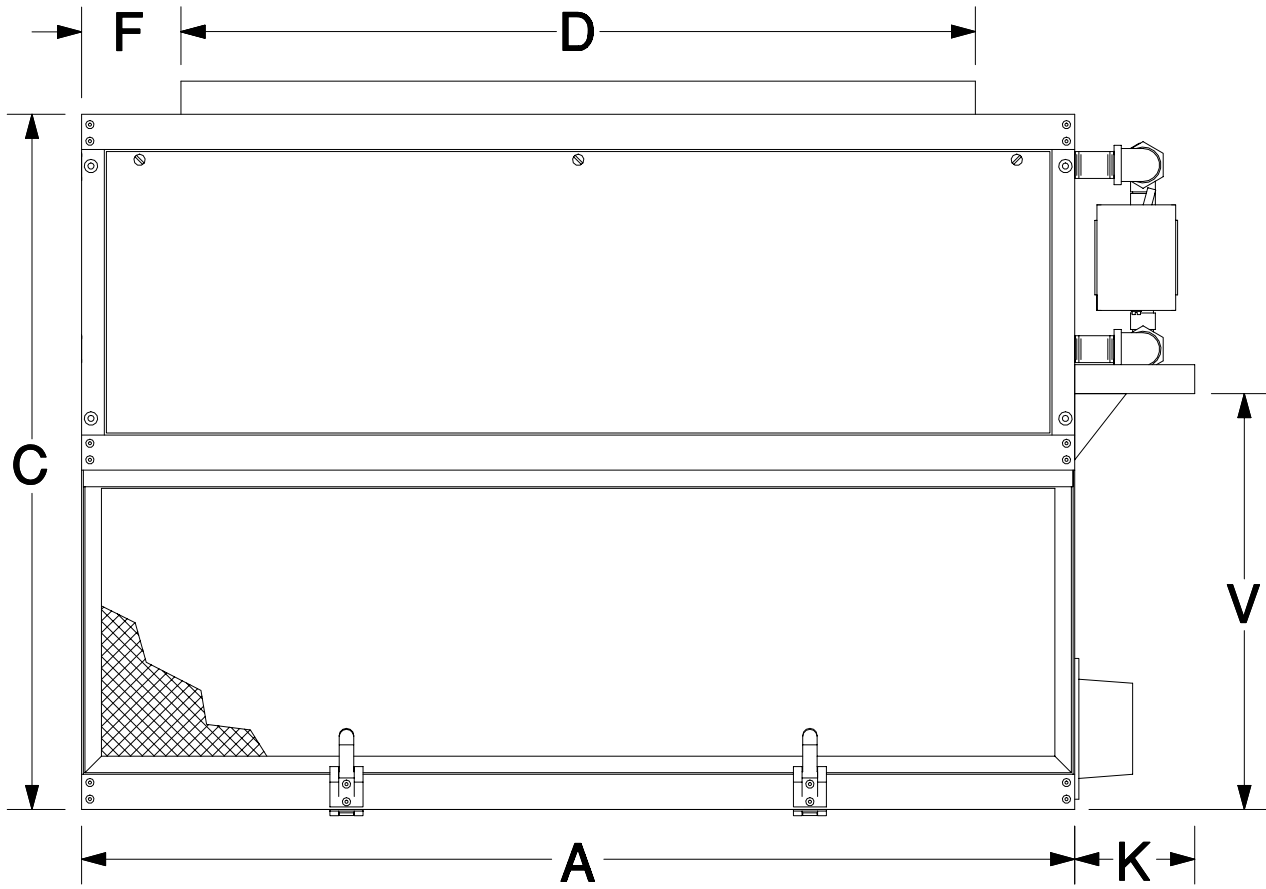

AQV-04 UNIT SHOWN

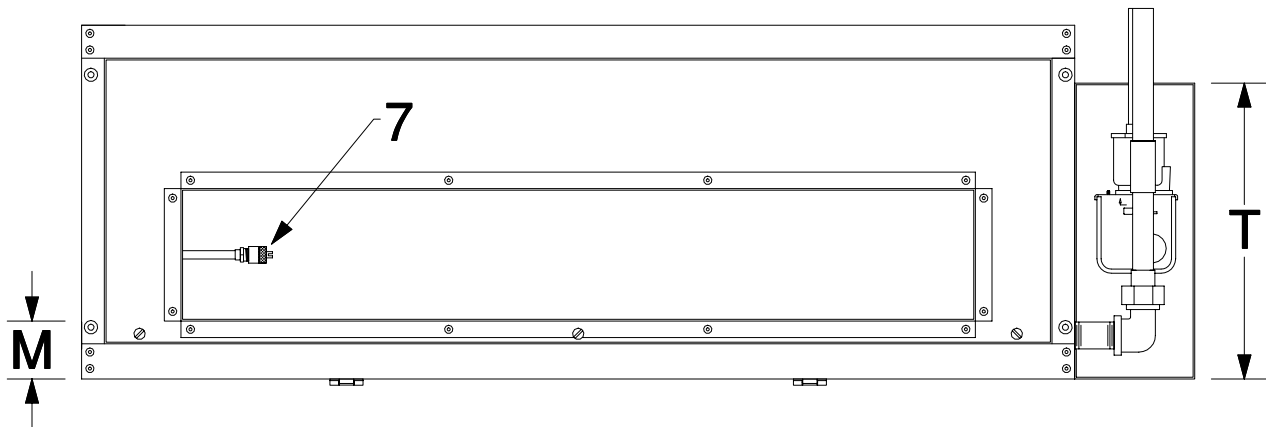

AQV
FAN COIL

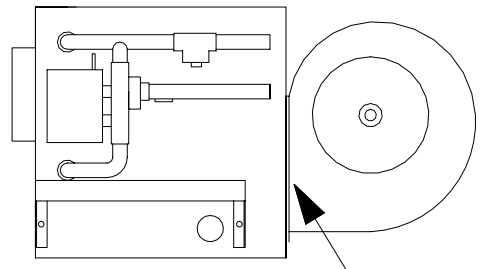

AQH
FAN COIL

FAN COIL #1

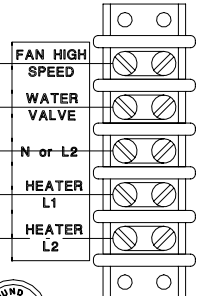

TERMINAL STRIP FOR ALL AQH, AQP & AQV FAN COILS WILL BE LOCATED ON THE BLOWER MOTOR TRAY.

MULTIPLE FAN COILS CAN BE CONNECTED IN PARALLEL TO THE THERMOSTAT PROVIDED THEY DO NOT EXCEED THE MAXIMUM AMPERAGE RATINGS OF THE CONTROL MODULE

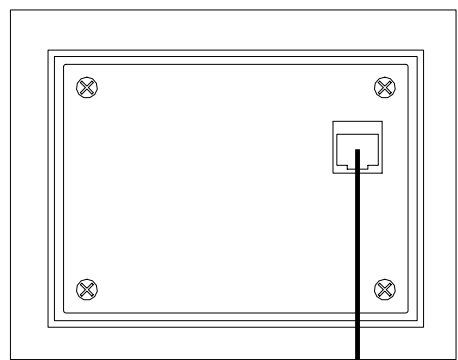

DISPLAY HEAD

INLET WATER SENSOR NOTE
ATTACH SENSOR TO THE WATER INLET LINE AT FAN COIL WATER VALVE

SENSORS

- INLET WATER SENSOR
- ROOM AIR SENSOR

DISPLAY CABLE 15'

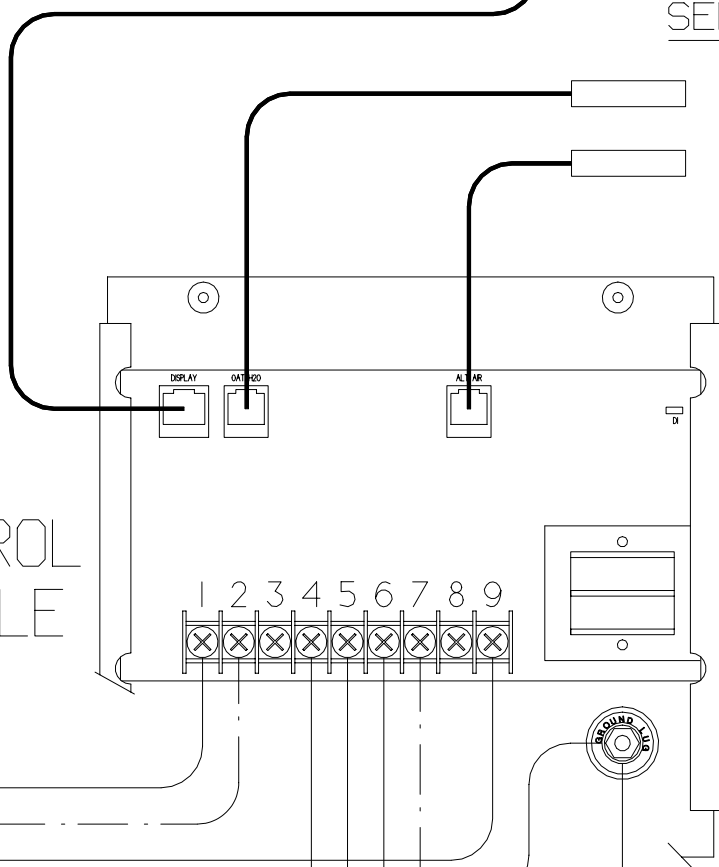

CONTROL MODULE

MAXIMUM CIRCUIT RATINGS

- WATER VALVE 1/4A
- FAN MOTOR 6A
- HEATER 20A

TERMINAL BLOCK CONNECTIONS

1. HEATER ELEMENT L1
2. HEATER ELEMENT L2
3. N/A
4. WATER VALVE L2
5. WATER VALVE L1
6. POWER INPUT L1
7. POWER INPUT L2 or N
8. FAN L2
9. FAN L1

NOTE: ALL L2's ARE COMMON TO EACH OTHER

POWER INPUT
115/1/60
200-230/1/50-60

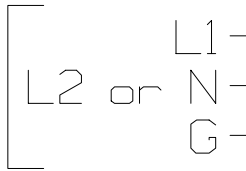

NOTE: FAN COIL MOTOR, WATER VALVE & HEATER MUST BE RATED FOR THE SAME VOLTAGE AS THE POWER INPUT.

AQUA-AIR MARINE AIR CONDITIONING SYSTEMS

TW2W DIGITAL THERMOSTAT w/ SINGLE AQH/AQP/AQV STYLE FAN COIL 115 or 230V w/ SINGLE PHASE ELECTRIC HEATERS

| | | | | | |
|----------------|---------|-------------|----|---------------|---------|
| DRAWING NUMBER | 4008-48 | DRAWN BY | DN | DATE | 2-26-98 |
| SCALE | NONE | APPROVED BY | | REVISION DATE | |
| | | | | | REV A |